



4 Bexley High Street, Bexley, Kent
DA5 1AD

Tel: 01322 522111

Email: bexley@village-estates.com

www.village-estates.com



* SPACIOUS 2 BEDROOM BUNGALOW * TRANQUIL CRESCENT *

* CLOSE TO SHOPS AND AMENITIES * EXCELLENT SCHOOL CATCHMENT * LARGE
CONSERVATORY * NO FORWARD CHAIN*

* OFF ROAD PARKING FOR 2/3 CARS * WELL PRESENTED THROUGHOUT *

* LARGE REAR GARDEN * VIEWING ADVISED *



7 Derwent Crescent
Bexleyheath, DA7 4NH

Guide Price £489,950 - £499,950

Village Estates are delighted to present to the market this spacious TWO BEDROOM BUNGALOW offered to the market with the added benefit of NO FORWARD CHAIN. Tucked away in a tranquil crescent within a short walk of local schools, shops and amenities. Offering generous accommodation throughout, viewing comes highly recommended...



EPC RATING D
COUNCIL TAX BAND D

Derwent Crescent, DA7

Approximate Gross Internal Area = 79 sq m / 848 sq ft
Approximate Garage Internal Area = 11 sq m / 116 sq ft
Approximate Outbuilding Internal Area = 4 sq m / 42 sq ft
Approximate Total Internal Area = 94 sq m / 1006 sq ft

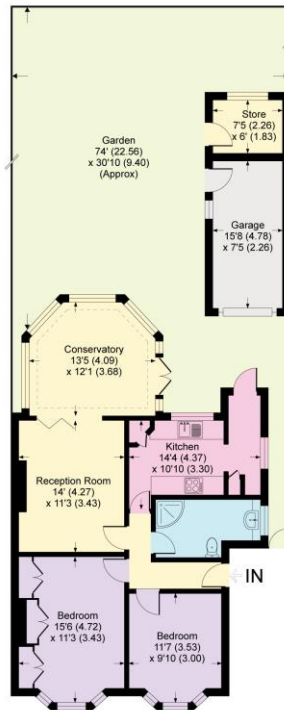

Ground Floor

This plan is for layout guidance only. Not drawn to scale unless stated. Windows and door openings are approximate. Whilst every care is taken in the preparation of this plan, please check all dimensions, shapes and compass bearings before making any decisions reliant upon them.
Produced by Planpix

We understand this property is Freehold.

VIEWING:

Via **Village Estates** on 01322 522111
Monday to Friday 9am-6pm, Saturday 9am-5pm
SELLING YOUR HOME?

If you are thinking of selling your own property, **VILLAGE ESTATES** will be pleased to provide you with a free market appraisal for sale purposes and professional marketing advice **FREE OF CHARGE, WITHOUT OBLIGATION**. Call one of our experienced sales staff on 01322 522111.

Whilst we endeavour to make our sales details reliable and accurate they should not be relied on as representations or statements of fact, and do not form any part of an offer or contract. The Seller does not make or give nor do we or our employees have authority to make or give any representation or warranty in relation to the property. We would strongly recommend that all the information which we provide about the property is verified by yourself on inspection and also by your conveyancer, especially where statements have been made by us to the effect that the information provided has not been verified. If there are any other points which are of particular importance to you, we would be only too happy to check the information and indeed confirm the availability of the property. Please contact the above office to arrange a convenient viewing appointment.